

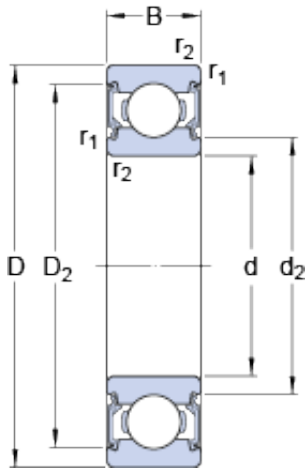

USK BEARING COMPANY



6 mm x 19 mm x 6 mm skf 626-2RSL Deep groove ball bearings

Bearing No. 626-2RSL

626-2RSL Bearing 2D drawings and 3D CAD models

Size	19x6x6 mm
Bore Diameter	19 mm
Outer Diameter	6 mm
Width	6 mm
d	6 mm
D	19 mm
B	6 mm
d ₂	9.5 mm
D ₂	16.5 mm
r _{1,2} - min.	0.3 mm
d _a - min.	8.4 mm
d _a - max.	9.4 mm
D _a - max.	16.6 mm
r _a - max.	0.3 mm
Basic dynamic load rating - C	2.3 kN
Basic static load rating - C ₀	0.95 kN
Fatigue load limit - P _u	0.04 kN
Reference speed	80000 r/min
Limiting speed	40000 r/min
Calculation factor - k _r	0.025
Calculation factor - f ₀	13
Category	Single Row Ball Bearings
Inventory	0.0
Manufacturer Name	SKF



USK BEARING COMPANY

Minimum Buy Quantity	N/A
Weight / Kilogram	0.01
Product Group	B00308
Enclosure	2 Seals
Precision Class	ABEC 1 ISO P0
Maximum Capacity / Filling Slot	No
Rolling Element	Ball Bearing
Snap Ring	No
Internal Special Features	No
Cage Material	Steel
Enclosure Type	Contact Seal
Internal Clearance	C0-Medium
Inch - Metric	Metric
Long Description	6MM Bore; 19MM Outside Diameter; 6MM Outer Race Width; 2 Seals; Ball Bearing; ABEC 1 ISO P0; No Filling Slot; No Snap Ring; No Internal Special Features; C0-Medium Internal Clearance; Steel Cage; Co
Other Features	Deep Groove Low Friction NBR Seal
Category	Single Row Ball Bearing
UNSPSC	31171504
Harmonized Tariff Code	8482.10.50.68
Noun	Bearing
Keyword String	Ball
Manufacturer URL	http://www.skf.com
Manufacturer Item Number	626-2RSL
Weight / LBS	0.0227
Inner Race Width	0 Inch 0 Millimeter
Outer Race Width	0.236 Inch 6 Millimeter
Outside Diameter	0.748 Inch 19 Millimeter



USK BEARING COMPANY

Bore	0.236 Inch 6 Millimeter
bore diameter:	6 mm
static load capacity:	0.95 kN
outside diameter:	19 mm
finish/coating:	Uncoated
overall width:	6 mm
bearing material:	Steel
bore type:	Round
cage material:	Steel
closure type:	Double Sealed
fillet radius:	0.3 mm
row type & fill slot:	Single Row Non-Fill Slot
maximum rpm:	80000 rpm
snap ring included:	Without Snap Ring
weight:	0.018 lb
operating temperature range:	-40 to 212 ° F ° F
manufacturer product page:	Click here
dynamic load capacity:	2.34 kN
manufacturer upc number:	7316571839950
d_2	9.5 mm
D_2	16.5 mm
d_a min.	8.4 mm
d_a max.	9.4 mm
D_a max.	16.6 mm
r_a max.	0.3 mm
Basic dynamic load rating C	2.34 kN
Basic static load rating C_0	0.95 kN
Fatigue load limit P_u	0.04 kN
Calculation factor k_r	0.025
Calculation factor f_0	13
Mass bearing	0.0083 kg