

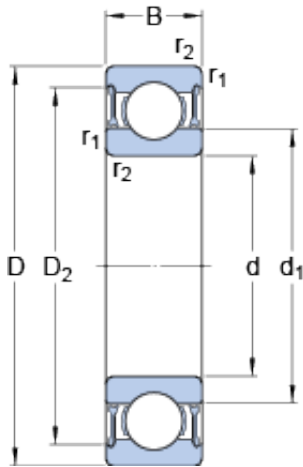

USK BEARING COMPANY



17 mm x 47 mm x 14 mm skf W 6303-2RZ Deep groove ball bearings

Bearing No. W 6303-2RZ

W 6303-2RZ Bearing 2D drawings and 3D CAD models

Size	47x17x14 mm
Bore Diameter	47 mm
Outer Diameter	17 mm
Width	14 mm
d	17 mm
D	47 mm
B	14 mm
d ₁	27.5 mm
D ₂	41.1 mm
r _{1,2} - min.	1 mm
D _a - max.	42 mm
r _a - max.	1 mm
Basic dynamic load rating - C	11.7 kN
Basic static load rating - C ₀	6.6 kN
Fatigue load limit - P _u	0.28 kN
Reference speed	36000 r/min
Limiting speed	18000 r/min
Calculation factor - k _r	0.035
Calculation factor - f ₀	12.4
d ₁	27.5 mm
D ₂	41.1 mm
r _{1,2} min.	1 mm
d _a min.	22 mm
d _a max.	27 mm



USK BEARING COMPANY

D_a max.	42 mm
r_a max.	1 mm
Basic dynamic load rating C	11.7 kN
Basic static load rating C_0	6.55 kN
Fatigue load limit P_u	0.28 kN
Calculation factor k_r	0.035
Calculation factor f_0	12.4
Mass bearing	0.11 kg