

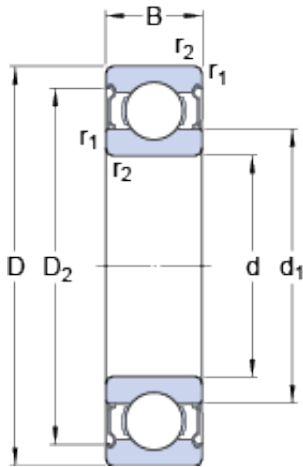

USK BEARING COMPANY



5 mm x 19 mm x 6 mm skf 635-2RS1 Deep groove ball bearings

Bearing No. 635-2RS1

635-2RS1 Bearing 2D drawings and 3D CAD models

Size	19x5x6 mm
Bore Diameter	19 mm
Outer Diameter	5 mm
Width	6 mm
d	5 mm
D	19 mm
B	6 mm
d ₁	11.1 mm
D ₂	16.5 mm
r _{1,2} - min.	0.3 mm
d _a - min.	7.4 mm
d _a - max.	10.6 mm
D _a - max.	16.6 mm
r _a - max.	0.3 mm
Basic dynamic load rating - C	2.3 kN
Basic static load rating - C ₀	0.95 kN
Fatigue load limit - P _u	0.04 kN
Limiting speed	24000 r/min
Calculation factor - k _r	0.03
Calculation factor - f ₀	13
Size	19x5x6 mm
Bore Diameter	19 mm
Outer Diameter	5 mm
Width	6 mm



USK BEARING COMPANY

d	5 mm
D	19 mm
B	6 mm
d ₁	11.1 mm
D ₂	16.5 mm
r _{1,2} - min.	0.3 mm
d _a - min.	7.4 mm
d _a - max.	10.6 mm
D _a - max.	16.6 mm
r _a - max.	0.3 mm
Basic dynamic load rating - C	2.3 kN
Basic static load rating - C ₀	0.95 kN
Fatigue load limit - P _u	0.04 kN
Limiting speed	24000 r/min
Calculation factor - k _r	0.03
Calculation factor - f ₀	13
d ₁	11.1 mm
D ₂	16.5 mm
d _a min.	7.4 mm
d _a max.	10.6 mm
D _a max.	16.6 mm
r _a max.	0.3 mm
Basic dynamic load rating C	2.34 kN
Basic static load rating C ₀	0.95 kN
Fatigue load limit P _u	0.04 kN
Calculation factor k _r	0.03
Calculation factor f ₀	13
Mass bearing	0.009 kg