

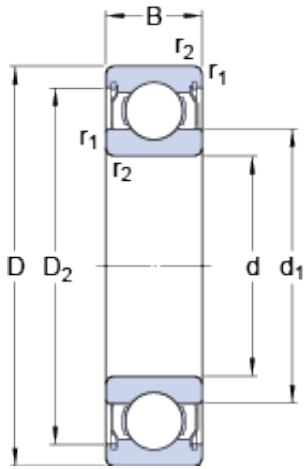

USK BEARING COMPANY



1.984 mm x 6.35 mm x 4.366 mm skf D/W
RW1-4-2ZS Deep groove ball bearings

Bearing No. D/W RW1-4-2ZS

D/W RW1-4-2ZS Bearing 2D drawings and 3D CAD models

Size	6.35x1.984x4.366 mm
Bore Diameter	6,35 mm
Outer Diameter	1,984 mm
Width	4,366 mm
d	1.984 mm
D	6.35 mm
B	4.366 mm
d ₁	3.92 mm
D ₂	5.75 mm
r _{1,2} - min.	0.1 mm
d _a - min.	mm
D _a - max.	mm
r _a - max.	0.1 mm
Basic dynamic load rating - C	0.163 kN
Basic static load rating - C ₀	0.048 kN
Fatigue load limit - P _u	0.002 kN
Reference speed	170000 r/min
Limiting speed	85000 r/min
Calculation factor - k _r	0.025
Calculation factor - f ₀	7
d ₁	3.92 mm
D ₂	5.75 mm
r _{1,2} min.	0.1 mm
d _a min.	0 mm



USK BEARING COMPANY

D_a max.	0 mm
r_a max.	0.1 mm
Basic dynamic load rating C	0.163 kN
Basic static load rating C_0	0.048 kN
Fatigue load limit P_u	0.002 kN
Calculation factor k_r	0.025
Calculation factor f_0	7
Mass bearing	0.0006 kg