

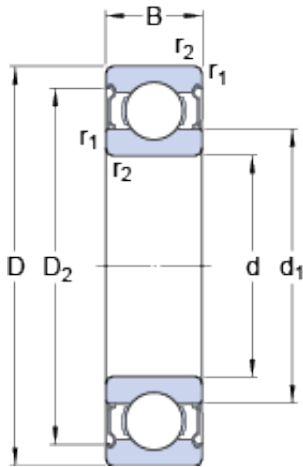

USK BEARING COMPANY



30 mm x 62 mm x 16 mm skf W 6206-2Z Deep groove ball bearings

Bearing No. W 6206-2Z

W 6206-2Z Bearing 2D drawings and 3D CAD models

| | |
|---|--------------------------|
| Size | 62x30x16 mm |
| Bore Diameter | 62 mm |
| Outer Diameter | 30 mm |
| Width | 16 mm |
| d | 30 mm |
| D | 62 mm |
| B | 16 mm |
| d ₁ | 40.7 mm |
| D ₂ | 55.1 mm |
| r _{1,2} - min. | 1 mm |
| d _a - min. | 35 mm |
| d _a - max. | 40.5 mm |
| D _a - max. | 57 mm |
| r _a - max. | 1 mm |
| Basic dynamic load rating - C | 19 kN |
| Basic static load rating - C ₀ | 11.4 kN |
| Fatigue load limit - P _u | 0.48 kN |
| Reference speed | 26000 r/min |
| Limiting speed | 13000 r/min |
| Calculation factor - k _r | 0.03 |
| Calculation factor - f ₀ | 13.9 |
| Category | Single Row Ball Bearings |
| Inventory | 0.0 |
| Manufacturer Name | SKF |



USK BEARING COMPANY

| | |
|---------------------------------|--|
| Minimum Buy Quantity | N/A |
| Weight / Kilogram | 0 |
| Product Group | B00308 |
| Enclosure | 2 Metal Shields |
| Precision Class | ABEC 1 ISO P0 |
| Maximum Capacity / Filling Slot | No |
| Rolling Element | Ball Bearing |
| Snap Ring | No |
| Internal Special Features | No |
| Cage Material | Stainless Steel |
| Internal Clearance | C0-Medium |
| Inch - Metric | Metric |
| Long Description | 30MM Bore; 62MM Outside Diameter; 16MM Outer Race Width; 2 Metal Shields; Ball Bearing; ABEC 1 ISO P0; No Filling Slot; No Snap Ring; No Internal Special Features; C0-Medium Internal Clearance; Stai |
| Other Features | Deep Groove |
| Category | Single Row Ball Bearing |
| UNSPSC | 31171504 |
| Harmonized Tariff Code | 8482.10.50.68 |
| Noun | Bearing |
| Keyword String | Ball |
| Manufacturer URL | http://www.skf.com |
| Weight / LBS | 0.4321 |
| Outer Race Width | 0.63 Inch 16 Millimeter |
| Outside Diameter | 2.441 Inch 62 Millimeter |
| Inner Race Width | 0 Inch 0 Millimeter |
| Bore | 1.181 Inch 30 Millimeter |
| d ₁ | 40.7 mm |



USK BEARING COMPANY

| | |
|--------------------------------|----------|
| D_2 | 55.13 mm |
| $r_{1,2}$ min. | 1 mm |
| d_a min. | 35 mm |
| d_a max. | 40.5 mm |
| D_a max. | 57 mm |
| r_a max. | 1 mm |
| Basic dynamic load rating C | 16.5 kN |
| Basic static load rating C_0 | 11.2 kN |
| Fatigue load limit P_u | 0.48 kN |
| Calculation factor k_r | 0.03 |
| Calculation factor f_0 | 13.9 |
| Mass bearing | 0.2 kg |